

# RESEARCH PROJECT STUDENT EXPO

## Student Exhibitors

Booth	Research Project Title
4 & 5	<p>What are the necessary types of intense training, technological knowledge and structural management an astronaut requires to live on the International Space Station (ISS) which helps benefit society on Earth?</p> <p>What is Space-time, and to what extent does it affect gravity?</p> <p>How can promotion and relegation be introduced to professional football in Australia?</p> <p>How does barefoot running compare to shod running?</p> <p>To what extent can a strength program improve Cyclo Cross performance?</p> <p>To what extent does cardio take effect on one's mental health?</p> <p>How can an individual maximise their mammalian dive response for the sport of freediving?</p>
10	<p>To what extent does desexing male dogs change their behaviour, and are the benefits worth the drama to the dog?</p> <p>How can I improvise with chords to a pop song?</p> <p>The Obesity Prevention and Lifestyle (OPAL) program is a South Australian obesity prevention initiative, working to promote and support children to eat healthy and be active. How has the OPAL program impacted the South Australian communities where the program has been implemented and has it succeeded in its objectives?</p>
16 & 17	<p>How do you repair a second hand, damaged fibreglass surfboard?</p> <p>To what extent is it predicted that bionic prosthetics will bring ethical and social calamity?</p> <p>Writing an article that informs young adults aged 18 – 25 of the causal link between stress and Takotsubo Cardiomyopathy (Broken Heart Syndrome).</p> <p>Creating a feature article that effectively promotes the work of Destiny Rescue</p>
18 & 19	<p>What is the most viable method that can be used to accelerate a spacecraft to the speed of light?</p> <p>How similar are the beliefs of Christians to that of Norse Pagans?</p> <p>How significantly does Plato's "tripartite theory" of the soul reflect current neuropsychological research in relation to cognition and decision-making?</p> <p>What is the impact of plastic pollution on marine life and how can this environmental issue be solved?</p> <p>Why are certain dog breeds more adept for assisting and supporting individuals with PTSD?</p>

## Program & map Wednesday 9 August 2017

[sace.sa.edu.au/expo2017](http://sace.sa.edu.au/expo2017)

  @saceboard #RPstudentexpo

Booth	Research Project Title
22	<p>Can I restore a Stihl Chainsaw on a budget?</p> <p>What preparation is required to perform in a Drag Show?</p> <p>Tattoos and me - my real life experience of getting a tattoo</p>
23	<p>To what extent do western adults suffer from psychosomatic pain and how does that affect them?</p> <p>Genetics vs the environmental effect on the development of identical twins.</p> <p>To what extent is singing an effective language development activity for children between 0-3 years of age?</p> <p>Dance related topics</p> <p>PE related topics</p>
31	<p>How does participation in sport help engage indigenous Australian students with their studies?</p> <p>To what extent are oral medications a better treatment method than injectable medications for Relapsing-Remitting Multiple Sclerosis?</p> <p>To what extent does insulin pump therapy increase life benefits for Type 1 Diabetics?</p>
34	<p>To what extent has the threat of terrorism impacted global travel and tourism?</p> <p>To what extent can idiopathic scoliosis affect the self-esteem of adolescent girls?</p> <p>What are the processes involved in creating a video advertisement for promoting Adelaide</p>
37	<p>How can I establish a legally compliant, ethical, and successful fundraising charity?</p> <p>How effective is music therapy in assisting children with Autism Spectrum Disorder?</p> <p>How can special provisions be more accessible to year 11 and 12 students suffering from anxiety and depression?</p>
39	<p>Are designer babies the inevitable future or are we playing God in the womb?</p> <p>Is science the truth about evolution?</p>
41	<p>How can I create an effective bake sale to raise funds for Relay for Life?</p> <p>What promising strategies can be identified for While in response to the "Wuss variation" of the modern Scandinavian Defence in chess, with the move order 1.e4, d5, 2.Exd5 Nf6, 3.D4 Bg4 4.Be2?</p> <p>How can I bake, decorate and package a sponge cake for a 16 years old birthday for 8?</p>

# Presentations

Time	Topic	Presenter
<b>Session 1</b>		
9.30 am	Choosing your Research topic: A Helpful Guide and Q&A	Panel of university students, The University of Adelaide
10.00 am	Research Projects in 3 Minutes	Panel of university students Flinders University
10.30 am	Q&A with Paul Vasileff	Paul Vasileff Young Australian of the Year and founder of Paolo Sebastian
<b>Session 2</b>		
11.30 am	6 Tips for Conducting Research	Ella Ward Ehrenberg-Bass Institute for Marketing Science, UniSA
12.00 pm	The Art Gallery of South Australia – a place for curiosity and discovery.	Kylie Neagle The Art Gallery of South Australia
12.30 pm	Research Projects in 3 Minutes	Panel of university students Flinders University

## Presentations by the SACE Board of SA

Time	Topic	Presenter
<b>Session 1</b>		
9.45 am	Structure of the Research Project subject	Luke Nash SACE Board of South Australia
10.15 am	Deciding on a Research Project outcome mode	Rebecca De Graaf RP Teacher, Hope Christian College
<b>Session 2</b>		
11.45 am	What is meant by substantiation	Shelly Brown RP Teacher, Charles Campbell College
12.15 am	How will you be assessed in the Research Project	Adele Broster SACE Board of South Australia

Visit us at booths 43 and 44 – we can answer specific questions about the Research Project, together with presentations offering information and advice on the subject. You can also visit 360 Q&A (booth 42) to add to our living-graphic: leave comments, suggestions, general feedback or questions and submit your completed **passport** for a chance to win one of five prizes!

## Exhibiting Organisations

Booth	Organisation
1, 2 & 3	CITB Doorways 2 Construction
6	ASC
7, 8 & 9	Australia and New Zealand Driverless Vehicle Initiative
11 & 12	Flinders University
13	TAFE SA
14	CQUniversity Adelaide
15	NRM Education
21	South Australian Sports Institute
24	Association of Secondary Research Teachers
25 & 26	The University of Adelaide
27	The Art Gallery of South Australia
28	Airborne Research Australia
29	Rising Sun Pictures
30	Academy of Interactive Entertainment
32	AgCommunicators
33	State Library of South Australia
35 & 38	Australian Youth Aerospace Association
36	Australia's Science Channel
40	State Records of South Australia
42	360 Q&A (submit your passport here)
43 & 44	SACE Board

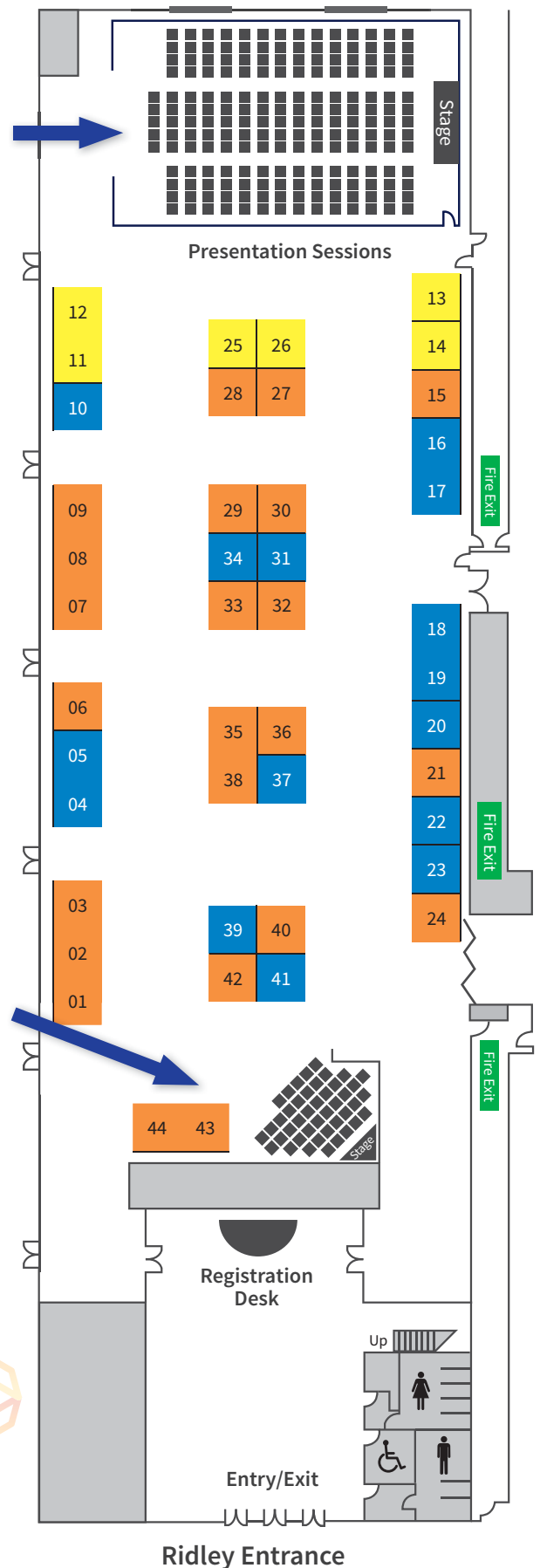

### Legend

- Organisation
- Tertiary
- Student Exhibitor